

con
tem
po
rary
soul
25

BONALDO

BONALDO

Contemporary Soul.

La casa è, e vuole essere, un sistema in continua trasformazione, un luogo in cui architettura e personalità si fondono in un dialogo sottile, dando vita a spazi che non si limitano a essere vissuti, ma che raccontano un'identità. Ogni scelta progettuale contribuisce a definire un ambiente che non è mai solo funzionale, ma diventa espressione di un'estetica intima e personale, capace di evolversi nel tempo senza perdere coerenza e significato.

Bonaldo, tra memoria ed evoluzione, dà forma a oggetti che abitano gli spazi e li trasformano in luoghi di significato, di esperienza e di relazione. Gli elementi d'arredo non sono meri accessori, ma frammenti di un racconto più ampio, capaci di imprimere carattere e atmosfera agli ambienti attraverso un dialogo con la luce, la materia e le geometrie dello spazio. Ogni creazione è il risultato di un pensiero progettuale che interpreta il vivere contemporaneo come una sintesi armonica tra radici e visione, tra cultura del design e pensiero creativo.

Contemporary Soul.

The home is and should be a system in constant transformation, a place in which architecture and personality converge in a subtle dialogue which gives life to spaces that are not limited to simply being lived in, but which present an identity. Each design choice contributes to defining an environment that is never just purely functional but which becomes the expression of an intimate and personal aesthetic, capable of evolving over time without losing coherence and meaning.

Midway between memory and evolution, Bonaldo gives shape and form to objects that inhabit spaces, and then transform them into places of meaning, experience and relationships. These furnishing elements are not just accessories; rather, they are parts of a larger narrative, capable of imbuing environments with character and atmosphere through the creation of dialogues with light, materials and the geometries of space. Each creation is the result of design thinking that interprets contemporary living as a harmonious synthesis between roots and vision, design culture and creative thought.

1

Tavolo / Table

Flatiron table

Sedia / Chair

Avant-Garde chair

Credenza / Sideboard

Arragan low

2

Tavolo / Table

Palazzo

Sedia / Chair

Mask, Miss Mask

3

Divano / Sofa

Brik

Poltrona / Armchair

Brik armchair

Pouf

Brik pouf

Tavolini / Coffee Table

Flatiron coffee table

Tappeto / Rug

Nairobi

4

Divano / Sofa

Belloalto

Poltrona / Armchair

Avant-Garde

Tavolini / Coffee Table

Isabey

Credenza / Sideboard

Arragan high

5

Letto / Bed

Nubo

Boiserie

Nubo boiserie

6

Letto / Bed

Oris

Complementi notte / Bed accessories

Arragan bedside table

Arragan drawer chest

Poltrona / Armchair

Bull

7

Sedia / Chair

Kagura

Poltrona / Armchair

Bull

Poltrona / Armchair

Boolean armchair

Poltrona / Armchair

Youpi lounge















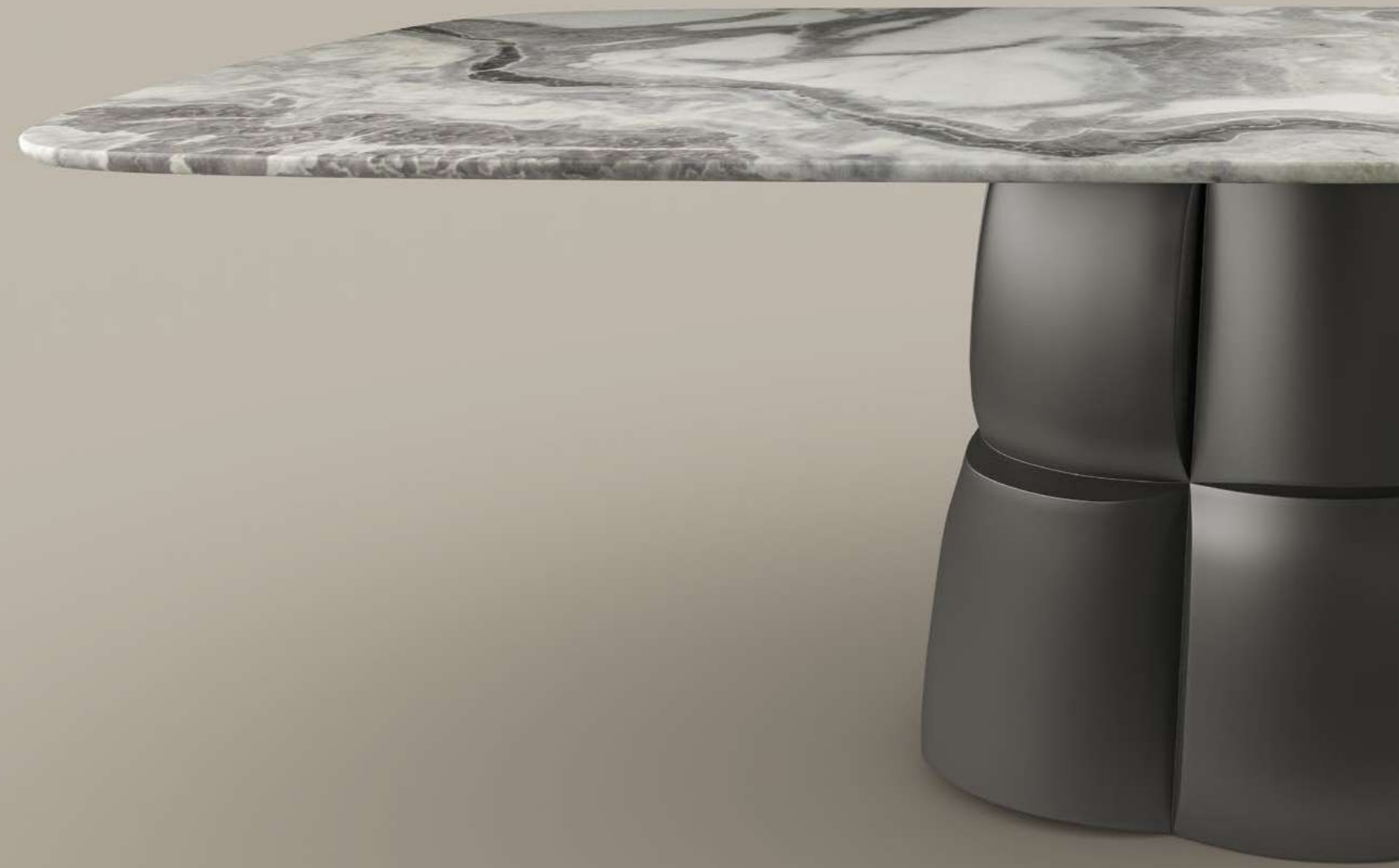









03_Contemporary Soul

Divano / Sofa

Brik

design Martina e Massimo Castagna

Poltrona / Armchair

Brik armchair

design Martina e Massimo Castagna

Pouf

Brik pouf

design Martina e Massimo Castagna

Tavolini / Coffee Table

Flatiron coffee table

design Mauro Lipparini

Tappeto / Rug

Nairobi































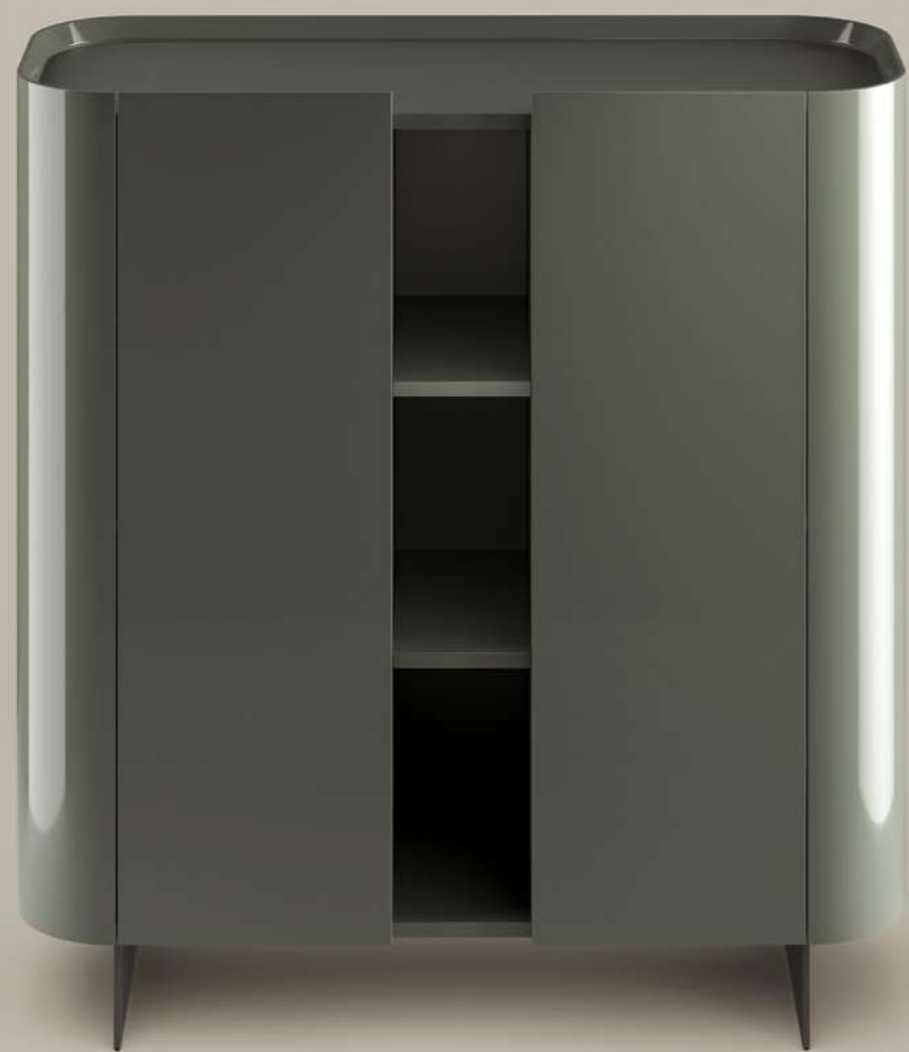









06_Contemporary Soul

Letto / Bed

Oris

design Gabriele e Oscar Buratti

Complementi notte / Bed accessories

Arragan bedside table

Arragan drawer chest

design Gabriele e Oscar Buratti

Poltrona / Armchair

Bull

design Gabriele e Oscar Buratti











88 Arragan drawer chest design Gabriele e Oscar Buratti

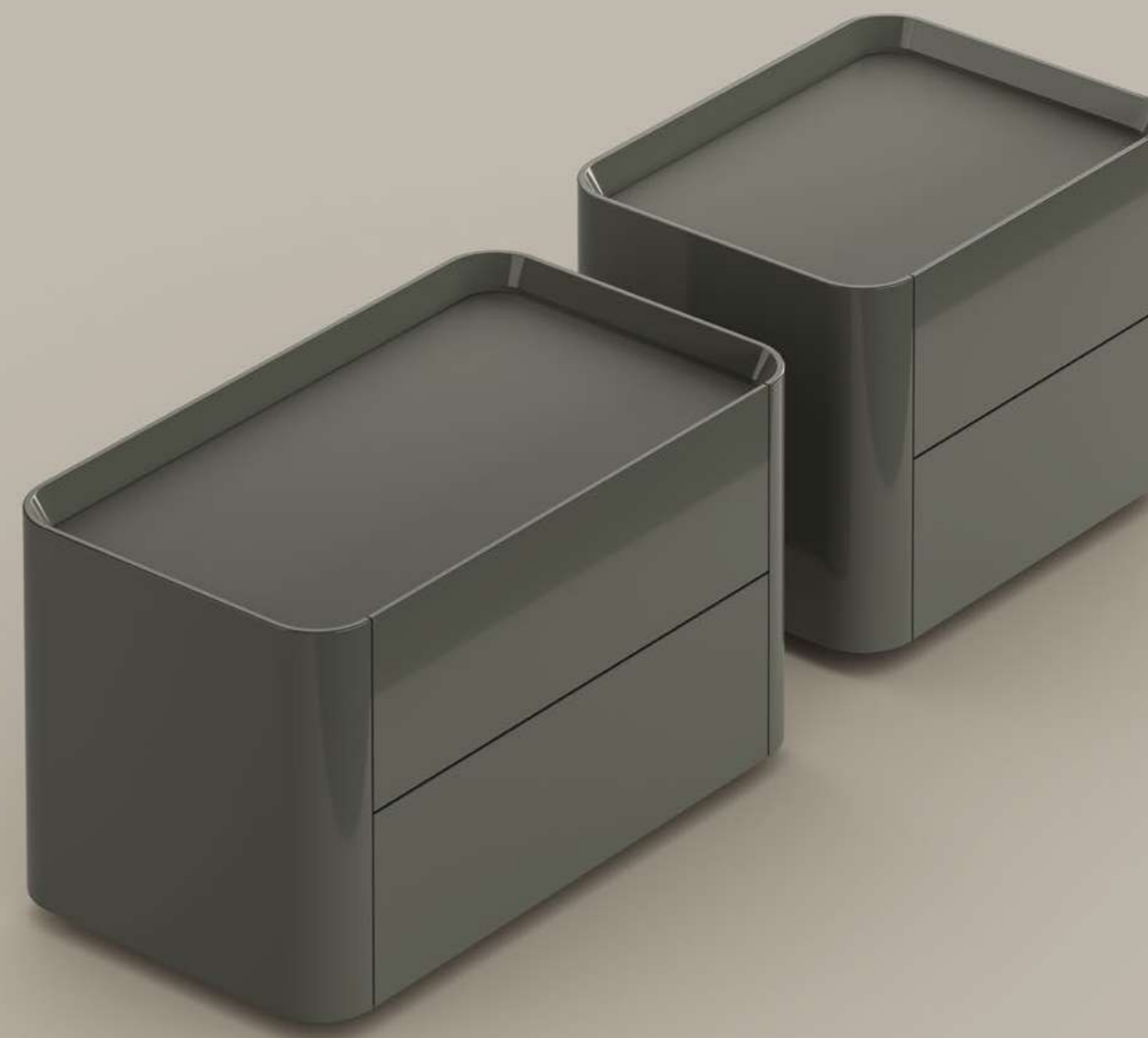

Arragan bedside table design Gabriele e Oscar Buratti

07_Contemporary Soul

Sedia / Chair

Kagura

design Toshiyuki Yoshino

Poltrona / Armchair

Bull

design Gabriele e Oscar Buratti

Poltrona / Armchair

Boolean armchair

design Giuseppe Viganò

Poltrona / Armchair

Youpi lounge

design Fabrice Berrux









Bull design Gabriele e Oscar Buratti











PAG. 04

SET 1

Tavolo Flatiron table 260x125 cm
design Mauro Lipparini
 piano in legno noce Canaletto
 base marmo opaco Travertino Romano
 inserto bronzo

Sedia Avant-Garde chair
design Fabrice Berrux
 rivestimento in pelle Capri L53
 asta bronzo

Madia Arragan low
design Gabriele e Oscar Buratti
 struttura in legno laccato grigio sabbia
 piedi piombo

Flatiron table 260x125 cm
Mauro Lipparini design
 Canaletto walnut top
 travertino Romano mat marble base
 bronze insert

Avant-Garde chair
Fabrice Berrux design
 cover in Capri L53 leather
 bronze rod

Arragan low sideboard
Gabriele and Oscar Buratti design
 frame and doors in sandgrey laquered wood
 lead feet

TAVOLO

Flatiron table

SEDIA

Avant-Garde chair

CREDENZA

Arragan low

TABLE

Flatiron table

CHAIR

Avant-Garde chair

SIDEBOARD

Arragan low

PAG. 20

SET 2

Tavolo Palazzo 300x120 cm
design Matilde Sessolo
 piano in marmo lucido Dover White
 base piombo

Sedia Mask
design Bonaldo Lab
 rivestimento in tessuto Lucky MD61

Palazzo table 300x120 cm
Matilde Sessolo design
 Dover White glossy marble top
 lead base

Mask chair
Bonaldo Lab design
 cover in Lucky MD61 fabric

TAVOLO

Palazzo

SEDIA

Mask

TABLE

Palazzo

CHAIR

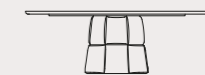
Mask



PAG. 32

SET 3

Divano Brik
design *Martina e Massimo Castagna*
rivestimento in pelle Panarea C03

Poltrona Brik armchair
design *Martina e Massimo Castagna*
rivestimento in tessuto Matisse ME14

Tavolino Flatiron coffee table 160
design *Mauro Lipparini*
piano in legno rovere carbone
bordo del piano e base in legno laccato piombo
inserto piombo

Tavolino Flatiron coffee table 120
design *Mauro Lipparini*
piano in legno rovere carbone
bordo del piano e base in legno laccato piombo
inserto piombo

Tappeto Nairobi 400x300 cm
acid green

DIVANO
Brik

SOFA
Brik

POLTRONE
Brik armchair

ARMCHAIRS
Brik armchair

TAVOLINI
Flatiron coffee table

COFFEE TABLES
Flatiron coffee table

TAPPETO
Nairobi

RUG
Nairobi

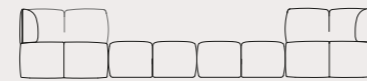

Brik sofa
Martina and Massimo Castagna design
cover in Panarea C03 leather

Brik armchair
Martina and Massimo Castagna design
cover in Matisse ME14 fabric

Flatiron coffee table 160
Mauro Lipparini design
Coal oak wood top
top edge and base in lead mat laquered wood
lead insert

Flatiron coffee table 120
Mauro Lipparini design
Coal oak wood top
top edge and base in lead mat laquered wood
lead insert

Nairobi rug 400x300 cm
acid green



PAG. 46

SET 4

Divano Belloalto
design *Gabriele e Oscar Buratti*
rivestimento in tessuto Petra SP81

Poltrona Avant-Garde
design *Fabrice Berrux*
rivestimento in tessuto Vegas MB14
asta piombo

Madia Arragan high
design *Gabriele e Oscar Buratti*
struttura e ripiani in legno laccato grigio vulcano
piedi piombo

Tavolino Isabey 160x95
design *Gabriele e Oscar Buratti*
piano in marmo lucido Calacatta
base in dark nickel

Tavolino Isabey 90x90
design *Gabriele e Oscar Buratti*
piano in legno rovere carbone
base in dark nickel

DIVANO
Belloalto

SOFA
Belloalto

POLTRONA
Avant-Garde

ARMCHAIR
Avant-Garde

CREDENZA
Arragan high

SIDEBOARD
Arragan high

TAVOLINI
Isabey

COFFEE TABLES
Isabey

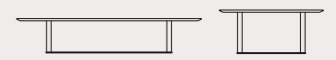
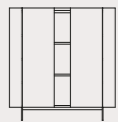

Belloalto sofa
Gabriele and Oscar Buratti design
cover in Petra SP81 fabric

Avant-Garde armchair
Fabrice Berrux design
cover in Vegas MB14 fabric
lead rod

Arragan high sideboard
Gabriele and Oscar Buratti design
frame and shelves in volcano grey laquered wood
lead feet

Isabey 160x95 coffee table
Gabriele and Oscar Buratti design
Calacatta glossy marble top
dark nickel base

Isabey 90x90 coffee table
Gabriele and Oscar Buratti design
coal oak top
dark nickel base



PAG. 68

SET 5

Letto Nubo 180x200 cm
design Massimo Castagna
 rivestimento in pelle Ponza Nabuk N04

Nubo Boiserie
design Massimo Castagna
 rivestimento in pelle Ponza Nabuk N01

Nubo bed 180x200 cm
Massimo Castagna design
 cover in Ponza Nabuk N04 leather

Nubo Boiserie
Massimo Castagna design
 cover in Ponza Nabuk N01 leather

LETTO
 CON BOISERIE

Nubo
Nubo boiserie

BED
 WITH BOISERIE

Nubo
Nubo boiserie

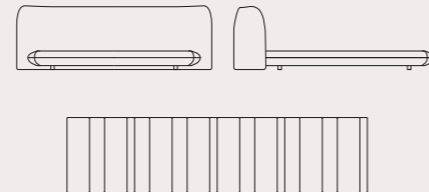

PAG. 78

SET 6

Letto Oris 180x200 cm
design Gabriele e Oscar Buratti
 rivestimento in pelle Capri L46

Comodino Arragan bedside table 80
design Gabriele e Oscar Buratti
 struttura in legno laccato grigio vulcano

Comodino Arragan bedside table 60
design Gabriele e Oscar Buratti
 struttura in legno laccato grigio vulcano

Poltrona Bull
design Gabriele e Oscar Buratti
 rivestimento in tessuto Hyle EB55
 base in legno massello noce Americano

Oris bed 180x200 cm
Gabriele and Oscar Buratti design
 cover in Capri L46 leather

Arragan bedside table 80
Gabriele and Oscar Buratti design
 frame in volcano grey laquered wood

Arragan bedside table 60
Gabriele and Oscar Buratti design
 frame in volcano grey laquered wood

Bull armchair
Gabriele and Oscar Buratti design
 cover in Hyle EB55 fabric
 American walnut solid wood base

LETTO
Oris

COMODINO
Arragan bedside table

POLTRONA
Bull

BED
Oris

BEDSIDE TABLE
Arragan bedside table

ARMCHAIR
Bull

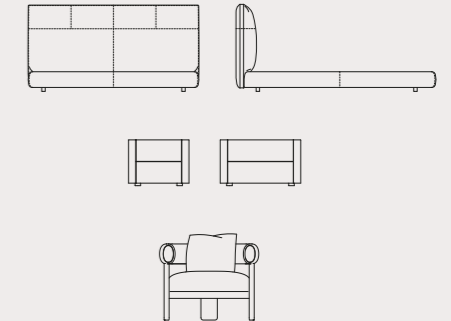

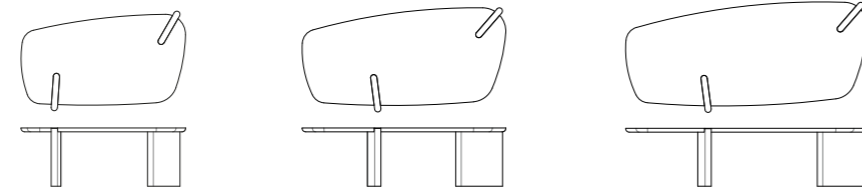

210 210 x 115 x h 75 cm - 82,6" x 45,3" x h 29,5"
260 260 x 125 x h 75 cm - 102,3" x 49,2" x h 29,5"
310 310 x 133 x h 75 cm - 122" x 52,4" x h 29,5"

FLATIRON TABLE
 DESIGN MAURO LIPPARINI

Nella foto
 260x125 cm
 Piano in legno noce Canaletto
 Base marmo opaco Travertino Romano
 Inserto bronzo

In photo
 260x125 cm
 Canaletto walnut top
 Travertino Romano mat marble base
 Bronze insert

MONO MATERIAL	MONO MATERIAL	DOUBLE MATERIAL	DOUBLE MATERIAL
<u>COMBINAZIONE 1</u>	<u>COMBINATION 1</u>	<u>COMBINAZIONE 1</u>	<u>COMBINATION 1</u>
PIANO E BASE Legno impiallacciato Noce Canaletto	TOP AND BASE Veneered wood Canaletto walnut	PIANO Legno impiallacciato Noce Canaletto	TOP Veneered wood Canaletto walnut
INSERTO Metallo Plus Bronzo	INSERT Plus metal Bronze	BASE Marmo opaco Travertino Romano	BASE Mat marble Travertino Romano
<u>COMBINAZIONE 2</u>	<u>COMBINATION 2</u>	INSERTO Metallo Plus Bronzo	INSERT Plus metal Bronze
PIANO E BASE Legno impiallacciato Rovere spazzolato Grey	TOP AND BASE Veneered wood Brushed Grey oak	<u>COMBINAZIONE 2</u>	<u>COMBINATION 2</u>
INSERTO Metallo Marrone	INSERT Metal Brown	PIANO Legno impiallacciato Rovere spazzolato Grey	TOP Veneered wood Brushed Grey oak
<u>COMBINAZIONE 3</u>	<u>COMBINATION 3</u>	BASE Marmo opaco Travertino Romano	BASE Mat marble Travertino Romano
PIANO E BASE Legno impiallacciato Rovere spazzolato carbone	TOP AND BASE Veneered wood Brushed coal oak	INSERTO Metallo Marrone	INSERT Metal Brown
INSERTO Metallo Plus Piombo	INSERT Plus metal Lead	<u>COMBINAZIONE 3</u>	<u>COMBINATION 3</u>
		PIANO Legno impiallacciato Rovere spazzolato carbone	TOP Veneered wood Brushed coal oak
		BASE Marmo opaco Carrara	BASE Mat marble Carrara
		INSERTO Metallo Plus Piombo	INSERT Plus metal Lead
		<u>COMBINAZIONE LIBERA</u>	<u>FREE COMBINATION</u>
		PIANO Legno impiallacciato Noce Canaletto Rovere spazzolato Grey Rovere spazzolato carbone	TOP Veneered wood Canaletto walnut Brushed Grey oak Brushed coal oak
		BASE Legno laccato opaco Bronzo Piombo	BASE Mat lacquered wood Bronze Lead
		INSERTO Metallo Plus Bronzo Piombo	INSERT Plus metal Bronze Lead



PALAZZO
 DESIGN MATILDE SESSOLO

Nella foto
 250x112 cm
 Piano in marmo lucido Dover White
 Base piombo

In photo
 250x112 cm
 Dover White glossy marble top
 Lead base

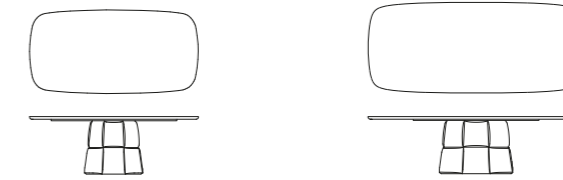

200 - 220 200 x 108 cm x h. - 79" x 42,5" x h.
220 220 x 110 cm x h. - 79" x 43,3" x h.
250 250 x 112 cm x h. - 98" x 44,1" x h.
280 280 x 115 cm x h. - 110" x 45,3" x h.
300 300 x 120 cm x h. - 118" x 47,2" x h.
300 300 x 140 cm x h. - 118" x 55,1" x h.

Altezza / Height
 ± h 75 cm / ± h 30"
 L'altezza del tavolo varia a seconda del materiale scelto per il piano. Per maggiori informazioni e approfondimenti consultare il listino prezzi. / The height of the table could change depending on the material of the top. For more information check the price list.

PIANO	TOP	200	220	250	280	300x120	300x140
Legno impiallacciato Noce Canaletto	Veneered wood Canaletto walnut	•		•			•
Legno massello Noce Americano	Solid wood American walnut	•		•			•
Rovere spazzolato carbone	Brushed coal oak	•		•			•
Rovere spazzolato Grey	Brushed Grey oak	•		•			•
Rovere spazzolato naturale	Brushed natural oak	•		•			•
Ceramica opaca Grigio Ardesia	Mat ceramic Ardesia grey	•	•	•			•
Laurent	Laurent	•	•	•			•
Alaska White	Alaska White	•	•	•			•
Augusta	Augusta	•	•	•			•
Ceramica lucida Calacatta	Glossy ceramic Calacatta	•	•	•			•
Black Onyx	Black Onyx	•	•	•			•
Imperial grey	Imperial grey	•	•	•			•
Mountain peak	Mountain peak	•	•	•			•
Rosso imperiale	Rosso imperiale	•	•	•			•
Ceramica finitura seta Calacatta Macchia Vecchia	Silk finish ceramic Calacatta Macchia Vecchia	•	•	•			•
Marmo lucido o opaco Carrara	Glossy or mat marble Carrara	•	•	•			•
Marquinia	Marquinia	•	•	•			•
Emperador	Emperador	•	•	•			•
Fior di Bosco	Fior di Bosco	•	•	•			•
Saint Denis	Saint Denis	•	•	•			•
Rosso Carpazi	Rosso Carpazi	•	•	•			•
Calacatta	Calacatta	•	•	•			•
Dover White	Dover White	•	•	•			•
Marmo opaco Travertino Romano	Mat marble Travertino Romano	•	•	•			•
BASE	BASE						
Poliuretano ad alta densità Bronzo Piombo	High density polyurethane Bronze Lead						
Finitura Clouded Chrome Brown nickel Dark nickel	Finish Clouded Chrome Brown nickel Dark nickel						



Avant-Garde chair

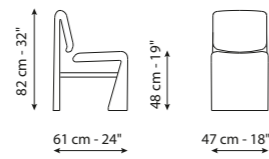

AVANT-GARDE CHAIR

DESIGN FABRICE BERRUX

Nella foto
Rivestimento in tessuto Vegas MB14
Asta piombo
-
In photo
Cover in Vegas MB14 fabric
Lead rod

IMBOTTITURA

Poliuretano schiumato
a freddo

RIVESTIMENTO

Tessuto
Ecopelle
Pelle

Non sfoderabile

ASTA

Metallo

Bianco
Marrone
Nero
Tortora
Supreme anthracite
Metallo Plus
Bronzo
Oro perlato
Piombo
Ottone opaco
Rame opaco
Metallo Special
Clouded Chrome
Brown nickel
Dark nickel

PADDING

Cold-foamed
polyurethane

COVER

Fabric
Eco leather
Leather

Not removable

ROD

Metal

White
Brown
Black
Dove grey
Supreme anthracite
Plus metal
Bronze
Pearl gold
Lead
Mat brass
Mat copper
Special metal
Clouded Chrome
Brown nickel
Dark nickel



Mask

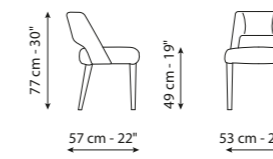

MASK

MISS MASK

DESIGN BONALDO LAB

Nella foto
Rivestimento in tessuto Lucky MD61
-
In photo
Cover in Lucky MD61 fabric

IMBOTTITURA

Gomma indeformabile
ad alta densità

RIVESTIMENTO

Tessuto
Ecopelle
Pelle

Non sfoderabile

PADDING

High density,
shrink-resistant foam

COVER

Fabric
Eco leather
Leather

Not removable

Miss Mask

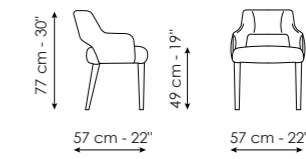

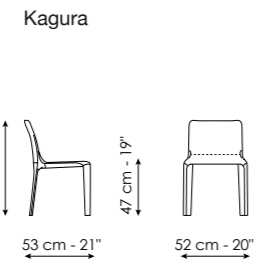

KAGURA

DESIGN TOSHIYUKI YOSHINO

Nella foto
Rivestimento in cuoio F19
-
In photo
Cover in F19 emery leather

IMBOTTITURA	PADDING
Gomma indeformabile ad alta densità	High density, shrink-resistant foam
RIVESTIMENTO	COVER
Cuoio (cuciture e bordo nero)	Emery leather (black stitching and edge)
PIEDE	FEET
Plastica con feltrino sostituibile	Plastic with replaceable felt pad



ARRAGAN LOW

DESIGN GABRIELE E OSCAR BURATTI

Nella foto
Struttura e ante in legno laccato grigio sabbia
Top aggiuntivo in ceramica Calacatta
Piedi piombo
-
In photo
Frame and doors in sandgrey lacquered wood
Calacatta ceramic additional top
Lead feet

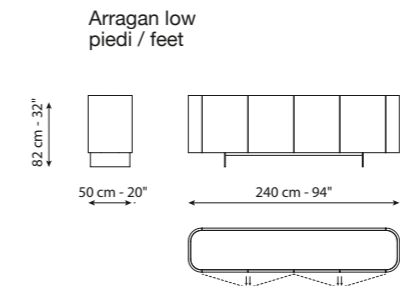

STRUTTURA E ANTE	FRAME AND DOORS
Legno laccato lucido o opaco Grigio sabbia Grigio vulcano	Glossy or mat lacquered wood Sandgrey Volcano grey
PIEDE	FEET
Metallo Plus Piombo	Plus metal Lead
BASE A ZOCCOLO	PLINTH BASE
Legno Nero	Wood Black
TOP AGGIUNTIVO	ADDITIONAL TOP
Ceramica opaca Augusta Ceramica lucida Calacatta Black Onyx Mountain peak Ceramica finitura seta Calacatta Macchia Vecchia	Mat ceramic Augusta Glossy ceramic Calacatta Black Onyx Mountain peak Silk finish ceramic Calacatta Macchia Vecchia
STRUTTURA INTERNA	INSIDE FRAME
Legno laccato opaco In tinta con la struttura esterna	Mat lacquered wood In a colour matching the external frame
RIPIANI INTERNI	INSIDE SHELVES
Cristallo Trasparente	Glass Transparent

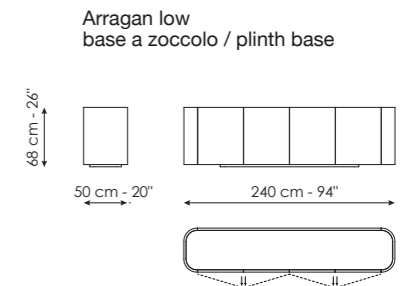



ARRAGAN HIGH

DESIGN GABRIELE
E OSCAR BURATTI

Nella foto
Struttura, ante e ripiani in legno
laccato grigio vulcano
Piedi piombo

In photo
Frame, doors and shelves in
volcano grey laquered wood
Lead feet

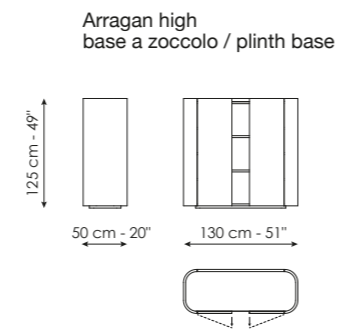
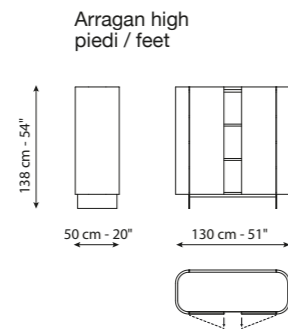

STRUTTURA E ANTE

**Legno laccato
lucido o opaco**
Grigio sabbia
Grigio vulcano

PIEDE

Metallo Plus
Piombo

BASE A ZOCCOLO

Legno
Nero

TOP AGGIUNTIVO

Ceramica opaca
Augusta
Ceramica lucida
Calacatta
Black Onyx
Mountain peak
Ceramica finitura seta
Calacatta Macchia
Vecchia

RIPIANI CENTRALI

Legno laccato opaco
In tinta con la struttura

STRUTTURA E RIPIANI INTERNI

Legno laccato opaco
In tinta con la struttura
esterna

FRAME AND DOORS

**Glossy or mat
lacquered wood**
Sandgrey
Volcano grey

FEET

Plus metal
Lead

PLINTH BASE

Wood
Black

ADDITIONAL TOP

Mat ceramic
Augusta
Glossy ceramic
Calacatta
Black Onyx
Mountain peak
Silk finish ceramic
Calacatta Macchia
Vecchia

CENTRAL SHELVES

Mat lacquered wood
In a color matching
the frame

FRAME AND INSIDE SHELVES

Mat lacquered wood
In a colour matching
the external frame



FLATIRON COFFEE TABLE

DESIGN MAURO LIPPARINI

Nella foto
Tavolino Flatiron coffee table 160
Piano in legno rovere carbone
Bordo del piano e base in legno
laccato piombo
Inserto piombo

Tavolino Flatiron coffee table 120
Piano in legno rovere carbone
Bordo del piano e base in legno
laccato piombo
Inserto piombo

In photo
Flatiron coffee table 160
Coal oak wood top
Top edge and base in lead mat
laquered wood
Lead insert

Flatiron coffee table 120
Coal oak wood top
Top edge and base in lead mat
laquered wood
Lead insert

Flatiron coffee table 160

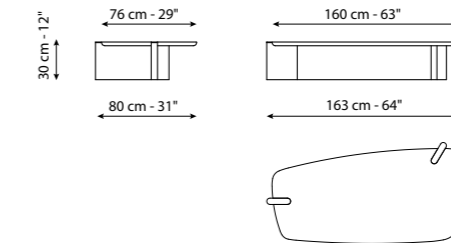

COMBINAZIONE 1

PIANO

Legno impiallacciato
Noce Canaletto

BORDO DEL PIANO E BASE

Legno laccato opaco
Bronzo

INSERTO

Metallo Plus
Bronzo

COMBINAZIONE 2

PIANO

Legno impiallacciato
Rovere carbone

BORDO DEL PIANO E BASE

Legno laccato opaco
Piombo

INSERTO

Metallo Plus
Piombo

COMBINATION 1

TOP

Veneered wood
Canaletto walnut

TOP EDGE AND BASE

Mat lacquered wood
Bronze

INSERT

Plus metal
Bronze

COMBINATION 2

TOP

Veneered wood
Coal oak

TOP EDGE AND BASE

Mat lacquered wood
Lead

INSERT

Plus metal
Lead

Flatiron coffee table 120

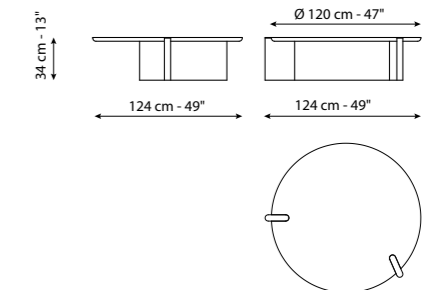

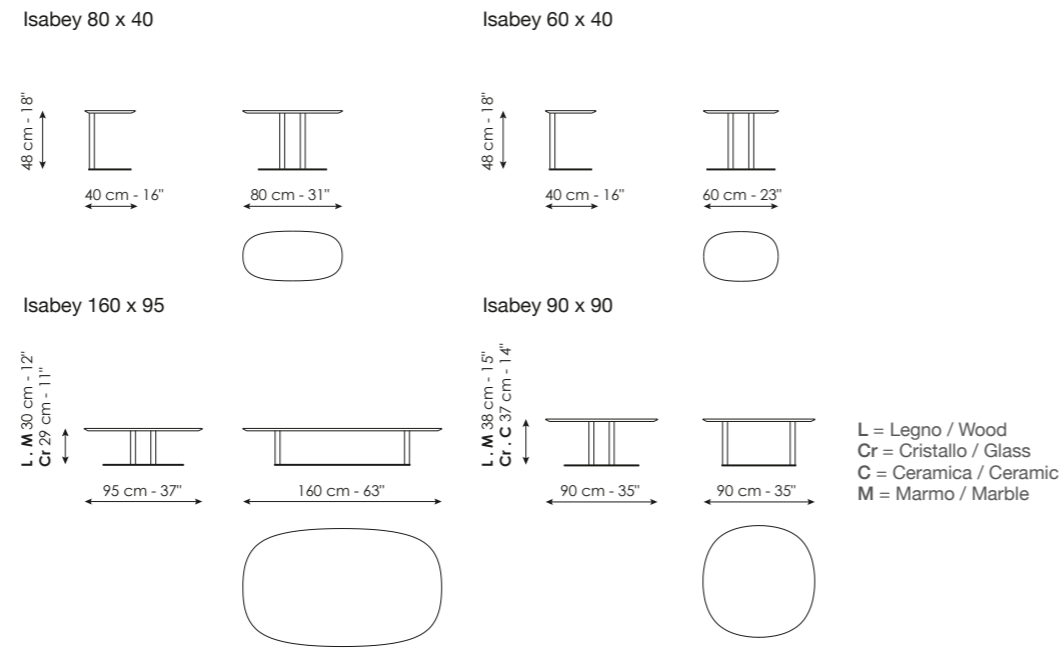

ISABEY
DESIGN GABRIELE
E OSCAR BURATTI

Nella foto
Tavolino Isabey 160x95
Piano in marmo lucido Calacatta
Base in dark nickel

Tavolino Isabey 90x90
Piano in legno rovere carbone
Base in dark nickel

In photo
Isabey 160x95 coffee table
Calacatta glossy marble top
Dark nickel base

Isabey 90x90 coffee table
Coal oak top
Dark nickel base

PIANO	TOP	160x95	90x90	60x40	80x40
Legno impiallacciato	Veneered wood				
Noce Canaletto	Canaletto walnut	•	•	•	•
Rovere carbone	Coal oak	•	•	•	•
Cristallo	Glass				
Fumé verniciato	Smoked painted	•	•	•	•
Ceramica opaca	Mat ceramic				
Grigio Ardesia	Ardesia grey			•	•
Laurent	Laurent			•	•
Alaska White	Alaska White			•	•
Augusta	Augusta		•	•	•
Ceramica lucida	Glossy ceramic				
Calacatta	Calacatta			•	•
Black Onyx	Black Onyx		•	•	•
Imperial grey	Imperial grey			•	•
Mountain peak	Mountain peak			•	•
Rosso imperiale	Rosso imperiale			•	•
Ceramica finitura seta	Silk finish ceramic				
Calacatta Macchia	Calacatta Macchia			•	•
Vecchia	Vecchia			•	•
Marmo lucido o opaco	Glossy or mat marble				
Carrara	Carrara	•	•		
Marquinia	Marquinia	•	•		
Emperador	Emperador	•	•		
Fior di Bosco	Fior di Bosco	•	•		
Saint Denis	Saint Denis	•	•		
Rosso Carpazi	Rosso Carpazi	•	•		
Calacatta	Calacatta	•	•		
Dover White	Dover White	•	•		
Marmo opaco	Mat marble				
Travertino Romano	Travertino Romano	•	•		
BASE	BASE				
Metallo	Metal			Metallo Special	Special metal
Bianco	White			Clouded Chrome	Clouded Chrome
Marrone	Brown			Brown nickel	Brown nickel
Nero	Black			Dark nickel	Dark nickel
Tortora	Dove grey				
Supreme anthracite	Supreme anthracite				
Metallo Plus	Plus metal				
Bronzo	Bronze				
Oro perlato	Pearl gold				
Piombo	Lead				
Ottone opaco	Mat brass				
Rame opaco	Mat copper				



AVANT-GARDE
AVANT-GARDE POUF
DESIGN FABRICE BERRUX

Nella foto
Poltrona Avant-Garde
Rivestimento in tessuto Vegas MB14
Asta piombo

Avant-Garde pouf
Rivestimento in tessuto Vegas MB14

In photo
Avant-Garde armchair
Cover in Vegas MB14 fabric
Lead rod

Avant-Garde pouf
Cover in Vegas MB14 fabric

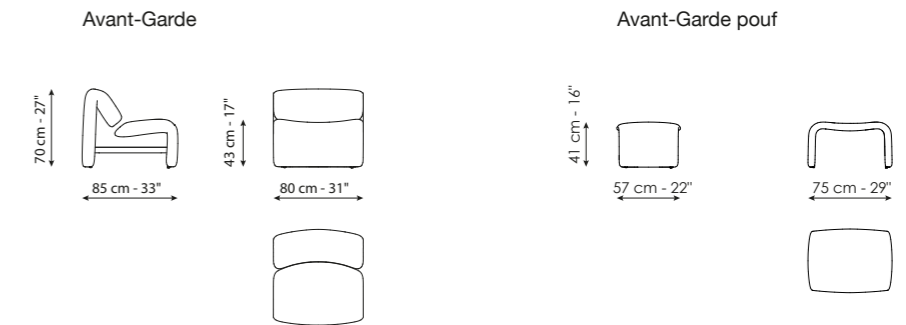

IMBOTTITURA	PADDING
Poliuretano schiumato a freddo	Cold-foamed polyurethane
RIVESTIMENTO	COVER
Tessuto	Fabric
Ecopelle	Eco leather
Pelle	Leather
<i>Non sfoderabile</i>	<i>Not removable</i>
ASTA	ROD
Metallo	Metal
Bianco	White
Marrone	Brown
Nero	Black
Tortora	Dove grey
Supreme anthracite	Supreme anthracite
Metallo Plus	Plus metal
Bronzo	Bronze
Oro perlato	Pearl gold
Piombo	Lead
Ottone opaco	Mat brass
Rame opaco	Mat copper
Metallo Special	Special metal
Clouded Chrome	Clouded Chrome
Brown nickel	Brown nickel
Dark nickel	Dark nickel

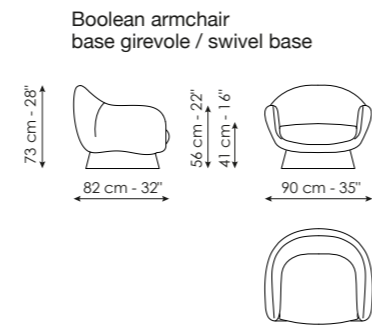
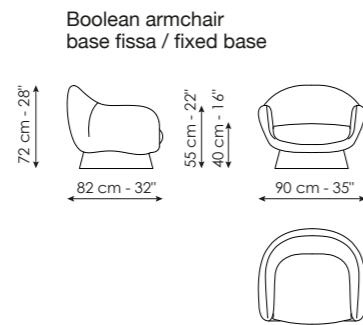

BOOLEAN ARMCHAIR
BASE RIVESTITA/COVERED BASE
DESIGN GIUSEPPE VIGANÒ

Nella foto
Rivestimento e base in
tessuto Ombra MD12
-
In photo
Cover and base in Ombra
MD12 fabric

IMBOTTITURA SEDUTA E SCHIENALE	SEAT AND BACKREST PADDING
Poliuretano schiumato a freddo	Cold-foamed polyurethane
IMBOTTITURA BASE	BASE PADDING
Poliuretano rigido	Stiff polyurethane
RIVESTIMENTO	COVER
Tessuto Pelle	Fabric Leather
<i>Non sfoderabile</i>	<i>Not removable</i>

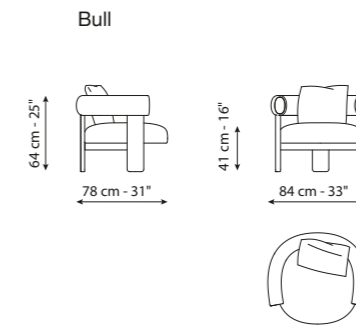

BULL
DESIGN GABRIELE
E OSCAR BURATTI

Nella foto
Rivestimento in tessuto Hyle EB55
Base in legno massello noce Americano
-
In photo
Cover in Hyle EB55 fabric
American walnut solid wood base

IMBOTTITURA SCHIENALE	BACKREST PADDING
Poliuretano schiumato a freddo	Cold-foamed polyurethane
IMBOTTITURA CUSCINO SEDUTA	SEAT CUSHION PADDING
Poliuretano espanso a varie densità	Polyurethane foam with various densities
RIVESTIMENTO	COVER
Tessuto Ecopelle Pelle	Fabric Eco leather Leather
<i>Non sfoderabile</i>	<i>Not removable</i>
BASE	BASE
Legno massello Noce Americano Rovere carbone	Solid wood American walnut Coal oak



Youpi lounge

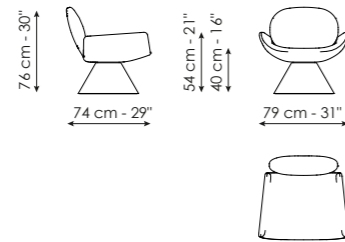

YOUPI LOUNGE

DESIGN FABRICE BERRUX

Nella foto
Rivestimento e base in
tessuto Lucky MD61

In photo
Cover and base in Lucky
MD61 fabric

IMBOTTITURA

Poliuretano schiumato
a freddo

RIVESTIMENTO

Tessuto
Ecopelle
Pelle

Non sfoderabile

BASE GIREVOLE

Rivestita nello stesso
tessuto/pelle selezionato
per il rivestimento

PADDING

Cold-foamed
polyurethane

COVER

Fabric
Eco leather
Leather

Not removable

SWIVEL BASE

Covered with the same
fabric/leather selected for
the cover



BELLOALTO
DESIGN GABRIELE
E OSCAR BURATTI

- RIVESTIMENTO **COVER**
- Tessuto **Fabric**
- Pelle **Leather**
- Sfoderabile (no pelle)* **Removable (no leather)**
- PIEDI **FEET**
- Metallo** **Metal**
- Nero **Black**
- IMBOTTITURA **PADDING**
- Poliuretano espanso a varie densità **Polyurethane foam padding with various densities**

Nella foto
Rivestimento in tessuto Petra SP81
-
In photo
Cover in Petra SP81 fabric

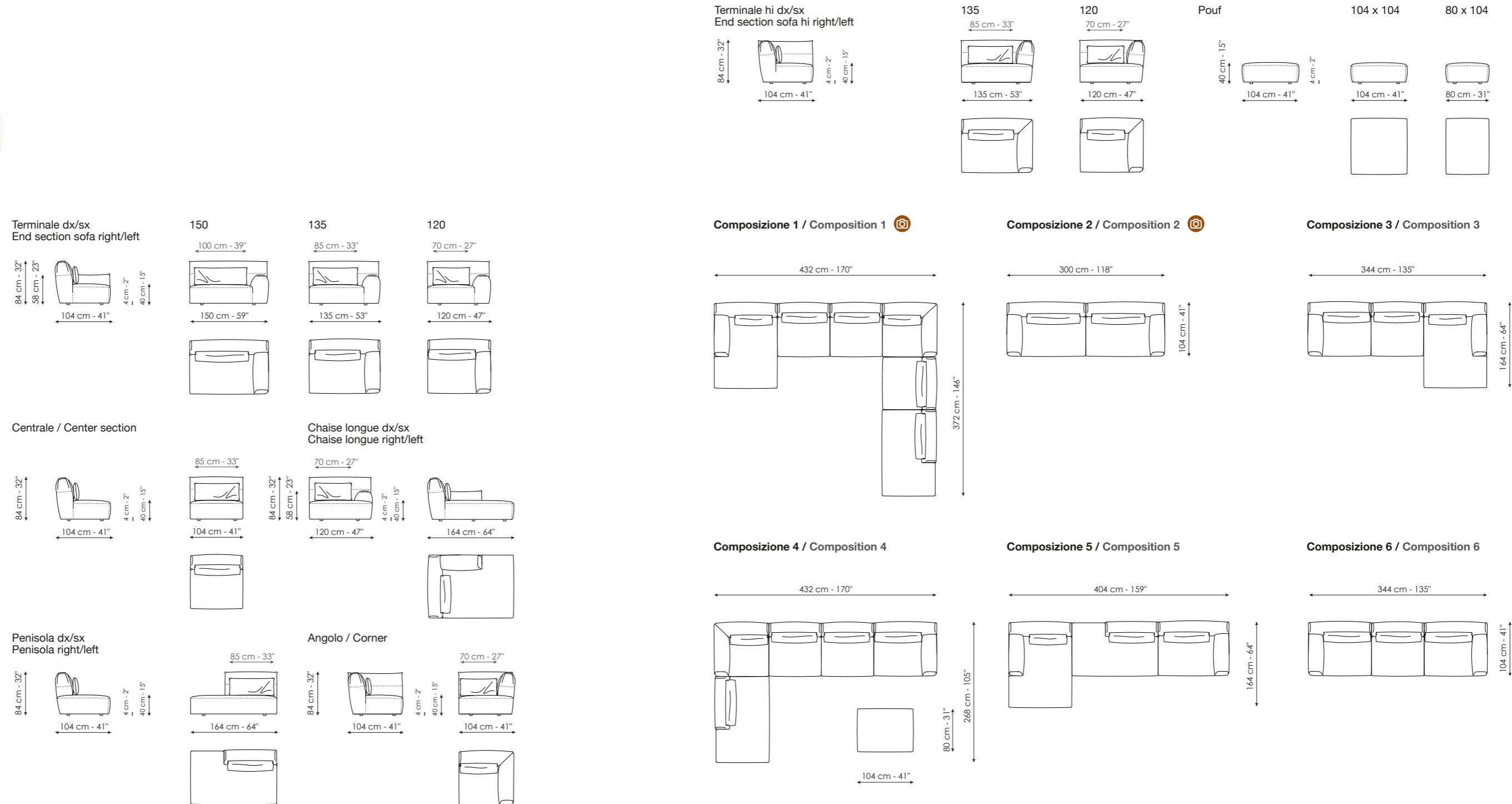



BRIK
DESIGN MARTINA
E MASSIMO CASTAGNA

RIVESTIMENTO COVER
Tessuto Fabric
Pelle Leather
Sfoderabile (no pelle) Removable (no leather)

IMBOTTITURA PADDING
Poliuretano espanso a varie densità Polyurethane foam padding with various densities

Nella foto
Divano Brik
Rivestimento in pelle Panarea C03

Poltrona Brik armchair
Rivestimento in tessuto Matisse ME14

Brik pouf
Rivestimento in pelle Panarea C03

In photo
Brik sofa
Cover in Panarea C03 leather

Brik armchair
Cover in Matisse ME14 fabric

Brik pouf
Cover in Panarea C03 leather

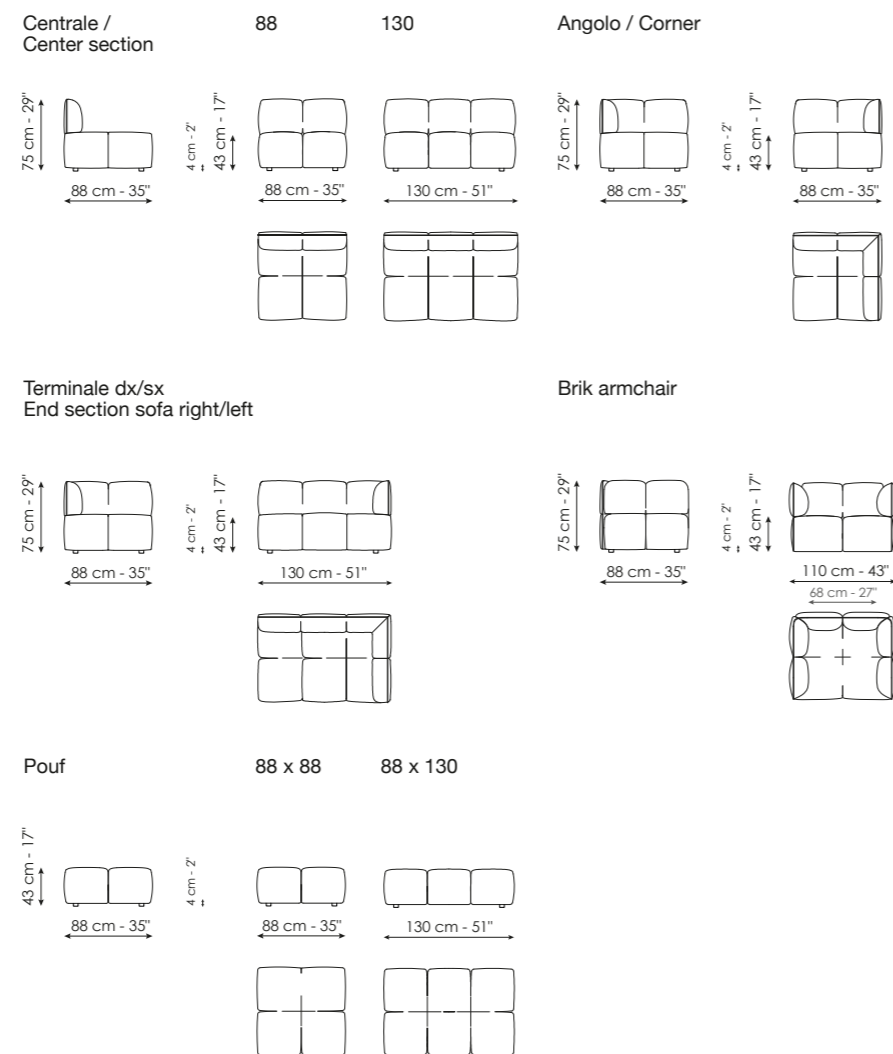

Composizione 1 / Composition 1

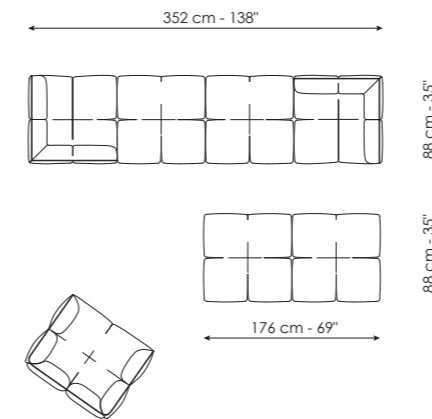

Composizione 4 / Composition 4

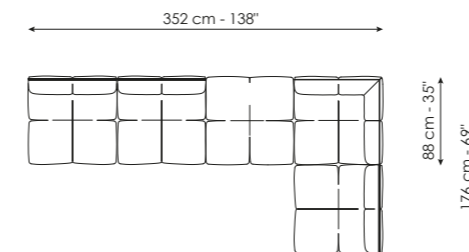

Composizione 2 / Composition 2

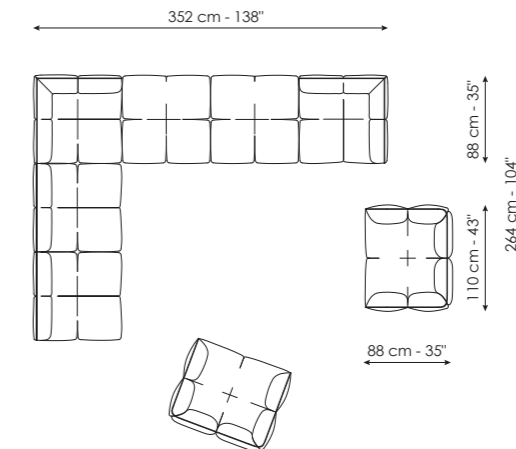

Composizione 5 / Composition 5

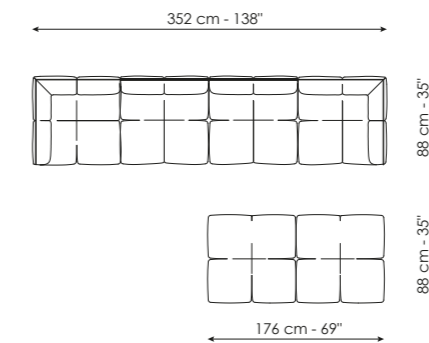

Composizione 3 / Composition 3

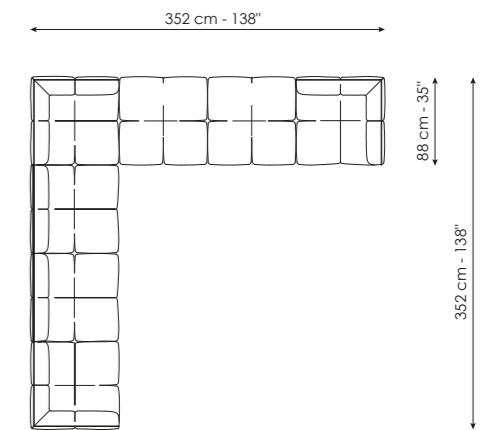

Composizione 6 / Composition 6

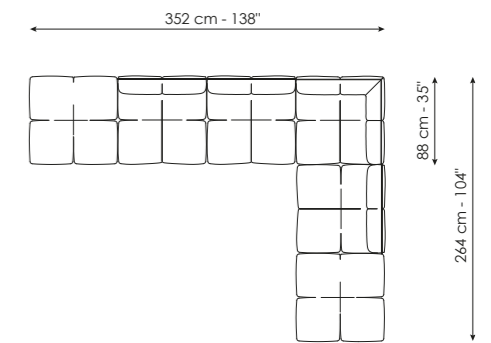



Nubo

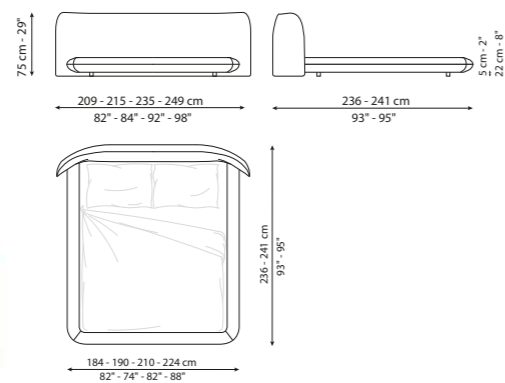

Nubo boiserie

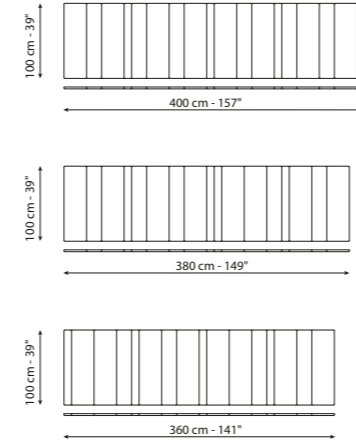

NUBO

NUBO BOISERIE

DESIGN MASSIMO CASTAGNA

RIVESTIMENTO

Tessuto
Ecopelle
Pelle

Sfoderabile (no pelle)

PIEDE

Metallo
Nero

IMBOTTITURA
TESTIERA

Poliuretano espanso
a varie densità

IMBOTTITURA
GIROLETTO

Poliuretano espanso
sagomato

COVER

Fabric
Eco leather
Leather

Removable (no leather)

FEET

Metal
Black

HEADBOARD
PADDING

Polyurethane foam
padding with various
densities

BED RING
PADDING

Shaped polyurethane
foam

Nella foto
Letto Nubo 180x200 cm
Rivestimento in pelle Ponza Nabuk N04

Nubo boiserie
Rivestimento in pelle Ponza Nabuk N01

In photo
Nubo bed 180x200 cm
Cover in Ponza Nabuk N04 leather

Nubo boiserie
Cover in Ponza Nabuk N01 leather



ORIS

DESIGN GABRIELE E OSCAR BURATTI

Nella foto
Letto Oris 180x200 cm
Rivestimento in pelle Capri L46

In photo
Oris bed 180x200 cm
Cover in Capri L46 leather

Oris

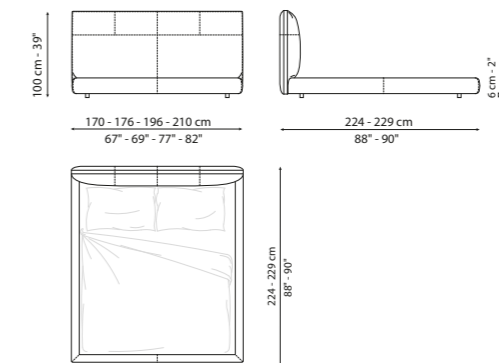

RIVESTIMENTO

Tessuto
Ecopelle
Pelle (cuciture a
contrasto)
Cuoio (cuciture a
contrasto)

*Sfoderabile (no pelle
e cuoio)*

PIEDE

Metallo
Nero

IMBOTTITURA

Poliuretano espanso
sagomato

COVER

Fabric
Eco leather
Leather (constrasting
stitching)
Emery leather
(constrasting stitching)

*Removable (no leather
and emery leather)*

FEET

Metal
Black

PADDING

Shaped polyurethane
foam



Arragan bedside table 60

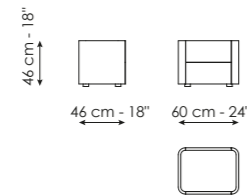

Arragan bedside table 80

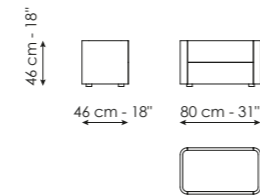

ARRAGAN BEDSIDE TABLE

DESIGN GABRIELE
E OSCAR BURATTI

Nella foto
Comodino Arragan bedside table 80
Struttura in legno laccato grigio vulcano

Comodino Arragan bedside table 60
Struttura in legno laccato grigio vulcano

In photo
Arragan bedside table 80
Frame in volcano grey laquered wood

Arragan bedside table 60
Frame in volcano grey laquered wood

STRUTTURA

**Legno laccato lucido
o opaco**
Grigio sabbia
Grigio vulcano

TOP AGGIUNTIVO

Ceramica opaca
Augusta
Ceramica lucida
Calacatta
Black Onyx
Mountain peak
Ceramica finitura seta
Calacatta Macchia
Vecchia

FRAME

**Glossy or mat
lacquered wood**
Sandgrey
Volcano grey

ADDITIONAL TOP

Mat ceramic
Augusta
Glossy ceramic
Calacatta
Black Onyx
Mountain peak
Silk finish ceramic
Calacatta Macchia
Vecchia



Arragan drawer chest

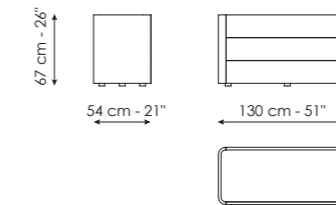

ARRAGAN DRAWER CHEST

DESIGN GABRIELE
E OSCAR BURATTI

Nella foto
Struttura in legno laccato grigio vulcano

In photo
Frame in volcano grey laquered wood

STRUTTURA

**Legno laccato lucido
o opaco**
Grigio sabbia
Grigio vulcano

TOP AGGIUNTIVO

Ceramica opaca
Augusta
Ceramica lucida
Calacatta
Black Onyx
Mountain peak
Ceramica finitura seta
Calacatta Macchia
Vecchia

FRAME

**Glossy or mat
lacquered wood**
Sandgrey
Volcano grey

ADDITIONAL TOP

Mat ceramic
Augusta
Glossy ceramic
Calacatta
Black Onyx
Mountain peak
Silk finish ceramic
Calacatta Macchia
Vecchia

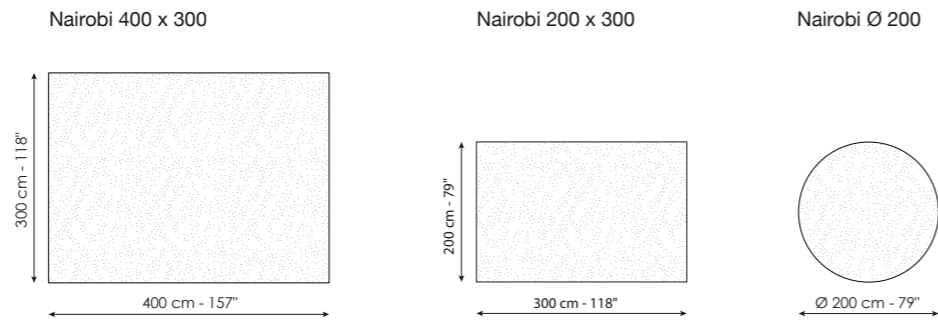

NAIROBI

Nella foto
 Tappeto Nairobi 400x300 cm
 Acid green
 -
In photo
 Nairobi rug 400x300 cm
 Acid green

COMPOSIZIONE

90% Tencel
 10% Cotone

Tappeto realizzato
 con la tecnica della
 tessitura a mano

COLORI

Acid green
 Olive green

COMPOSITION

90% Tencel
 10% Cotton

Rug made using
 the hand-woven
 technique

COLORS

Acid green
 Olive green

Tavoli / Tables



Flatiron table
pag. 06-11



Palazzo
pag. 22-27

Sedie / Chairs



Avant-Garde chair
pag.6-7, 12-15



Kagura
pag. 92-95



Mask, Miss Mask
pag. 24-25, 28-31

Tavolini / Coffee Tables



Flatiron coffee table
pag. 36-37, 42-45



Isabey
pag. 48-49, 60-63

Credenze / Sideboards



Arragan low
pag. 6-7, 16-19



Arragan high
pag. 48-49, 64-67

Divani / Sofas



Belloalto
pag. 48-55



Brik
pag. 34-41

Poltrone / Armchairs



Avant-Garde
Avant-Garde pouf
pag. 48-49, 56-59



Boolean armchair
pag. 100-103



Bull
pag. 80-81, 96-99



Yupi lounge
pag. 104-107

Letti / Beds



Nubo, Nubo boiserie
pag. 70-77



Oris
pag. 80-87

Complementi notte / Bed accessories



Arragan drawer chest
pag. 88



Arragan bedside tables
pag. 80-81, 89

Tappeti / Rugs



Nairobi
pag. 36-37

Concept
Bonaldo SpA

Graphic design
romanoassociati.com

Images
Garage 121

Styling
Candida Zanelli
Rosaria Sofia Galli

Pre-press and printing
Grafiche Antiga



Printed in Italy
April 2025

Bonaldo SpA si riserva il diritto di modificare, senza preavviso, materiali, rivestimenti, finiture e disegni dei prodotti presentati in questo catalogo. I colori e le finiture visualizzate sono puramente indicativi e possono differire dagli originali. Le immagini riprodotte nel presente catalogo sono di proprietà esclusiva di Bonaldo SpA. È vietata qualunque riproduzione o utilizzo delle immagini senza preventiva autorizzazione scritta di Bonaldo SpA.

Bonaldo SpA reserves the right to change, without any notice, materials, covers, finishes and drawings of the products of this catalogue. Colors and finishes shown are approximate and may differ from actual ones. All images in this catalogue are property of Bonaldo SpA. Every reproduction or use of the images without prior written authorization from Bonaldo SpA is therefore strictly forbidden.



www.bonaldo.com



Follow Bonaldo on WeChat

BONALDO

Bonaldo SpA a socio unico
via Straelle 3, 35010 Villanova di Camposampiero (PD) Italy tel + 39 049.9299011
info@bonaldo.com www.bonaldo.com



